

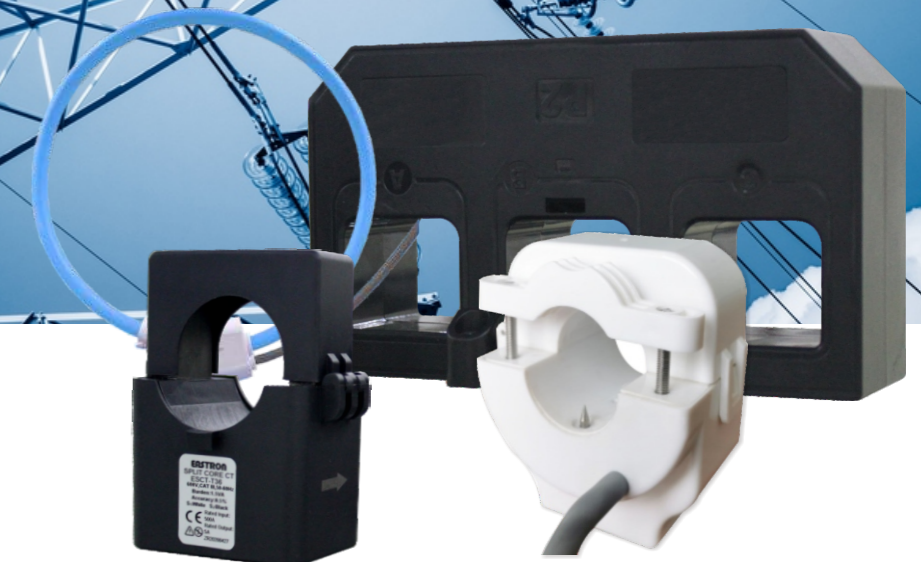

Innovation · Quality · Services



Current Transformer Catalog

Split Core · Solid Core · 3 in 1 · Rogowski Coil · RJ Connection · Puncture Type



Web: www.eastrongroup.com
E-mail: sales@eastrongroup.com
Tel: +86-573-8369881 Fax: +86-573-83698883
Add: No.1369, Chengnan Rd. Jiangxing. Zhejiang, 314001, China

Zhejiang Eastron Electronic Co., Ltd.

www.eastrongroup.com



ESCT-T Series SPLIT CORE CURRENT TRANSFORMER

- Split Core, easy installation
- Primary input 100A~600A
- Secondary output 5A / 1A
- Safe operation
- Standard: IEC60044-1, EN60044-1, VDE0414-44-1, GB1208-2006



ESCT-TU Series MINI SPLIT CORE CURRENT TRANSFORMER

- Split Core, easy installation
- Primary input 5A~600A
- Secondary output 333mV / 100mV / 100mA
- Safe operation
- Standard: IEC60044-1, EN60044-1, VDE0414-44-1, GB1208-2006

Specification

Frequency	50-60Hz
Rated current	100A to 600A loads
Rated output	1A / 5A (AC)
Accuracy	Class 0.5 or 1 from 20% to 120% of rated current
Phase angle	Less than 2 degrees at 50% of rated current
Insulation voltage	600Vac
Maximum primary voltage	5000Vac (Insulated Conductor)
Dielectric strength	2.5KV/1mA/1min
Operating temperature	-12°C to +75°C.
Operating humidity	<85%
Case material	PC / UL94-V0
Bobbin	PBT
Core	Permalloy
Internal structure	Epoxy

Model	Ratio (A)	Burden (VA)	
		Class:0.5	Class:1.0
ESCT-T24-1	100/1	-	1.5
ESCT-T24-1	150/1	-	1.5
ESCT-T24-1	200/1	1.5	2.5
ESCT-T24-1	250/1	1.5	3.75
ESCT-T24-1	300/1	2.5	5
ESCT-T24-1	400/1	3.75	6.25
ESCT-T36-1	100/1	-	1
ESCT-T36-1	150/1	1.5	3.75
ESCT-T36-1	200/1	2.5	5
ESCT-T36-1	300/1	5	7.5
ESCT-T36-1	400/1	5	10
ESCT-T36-1	500/1	7.5	10
ESCT-T36-1	600/1	10	15
ESCT-T24-5	100/5	-	-
ESCT-T24-5	150/5	-	-
ESCT-T24-5	200/5	1	1.5
ESCT-T24-5	250/5	1.5	2.5
ESCT-T24-5	300/5	2.5	3.75
ESCT-T24-5	400/5	2.5	5
ESCT-T36-5	100/5	-	-
ESCT-T36-5	150/5	-	1
ESCT-T36-5	200/5	1	2.5
ESCT-T36-5	300/5	2.5	5
ESCT-T36-5	400/5	5	6.25
ESCT-T36-5	500/5	5	6.25
ESCT-T36-5	600/5	5	6.25

► Dimensions

ESCT-T24-1

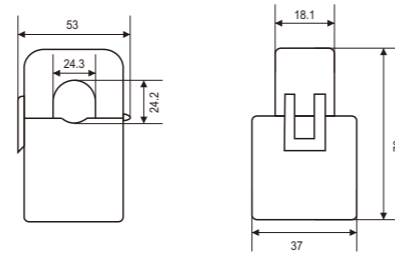

ESCT-T36-1

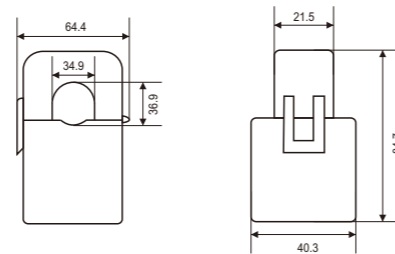

ESCT-T24-5

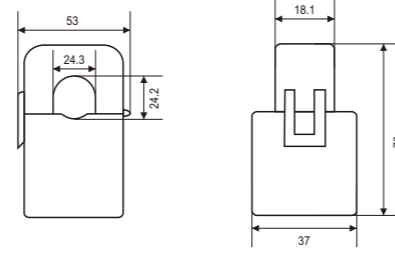

ESCT-T36-5

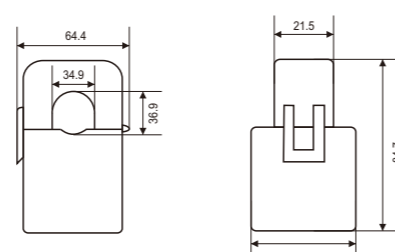

Specification

Frequency	50-60Hz
Rated current	5A to 600A loads
Rated output	100mA/333mV/100mV (AC)
Accuracy	Class 0.5 or 1 from 20% to 120% of rated current
Phase angle	less than 2 degrees at 50% of rated current
Insulation voltage	600Vac
Maximum primary voltage	5000Vac (Insulated Conductor)
Dielectric strength	2.5KV/1mA/1min
Operating temperature	-12°C to +75°C.
Operating humidity	<85%
Case material	PC / UL94-V0
Bobbin	PBT
Core	Permalloy
Internal structure	Epoxy
Leads	UL 1015, Twisted Pair, 22AWG

Model	Rated Amps	Output	Accuracy
ESCT-TU10	5	100mA/333mV/100mV	0.5/1/3
ESCT-TU10	10	100mA/333mV/100mV	0.5/1/3
ESCT-TU10	20	100mA/333mV/100mV	0.5/1/3
ESCT-TU10	50	100mA/333mV/100mV	0.5/1/3
ESCT-TU10	80	100mA/333mV/100mV	0.5/1/3
ESCT-TU16	10	100mA/333mV/100mV	0.5/1/3
ESCT-TU16	50	100mA/333mV/100mV	0.5/1/3
ESCT-TU16	100	100mA/333mV/100mV	0.5/1/3
ESCT-TU16	120	100mA/333mV/100mV	0.5/1/3
ESCT-TU24	10	100mA/333mV/100mV	0.5/1/3
ESCT-TU24	50	100mA/333mV/100mV	0.5/1/3
ESCT-TU24	100	100mA/333mV/100mV	0.5/1/3
ESCT-TU24	250	100mA/333mV/100mV	0.5/1/3
ESCT-TU24	400	100mA/333mV/100mV	0.5/1/3
ESCT-TU36	20	100mA/333mV/100mV	0.5/1/3
ESCT-TU36	100	310mA/333mV/100mV	0.5/1/3
ESCT-TU36	250	100mA/333mV/100mV	0.5/1/3
ESCT-TU36	400	100mA/333mV/100mV	0.5/1/3
ESCT-TU36	600	100mA/333mV/100mV	0.5/1/3

► Dimensions

ESCT-TU10

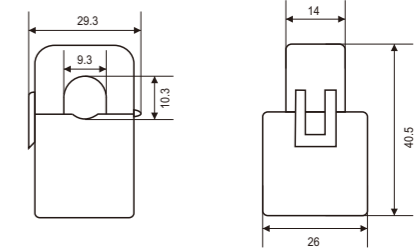

ESCT-TU16

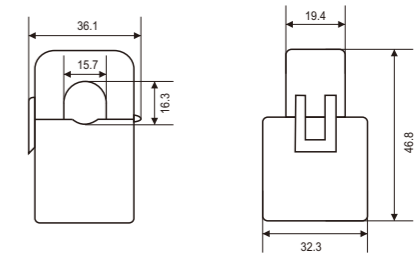

ESCT-TU24

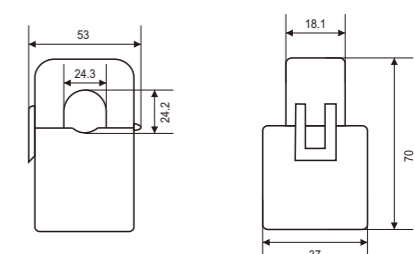

ESCT-TU36

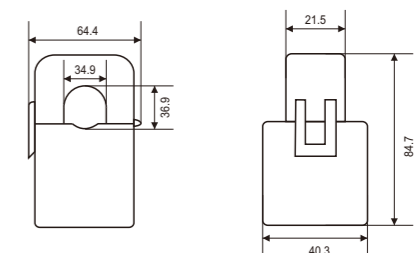



ESCT-U Series

SPLIT CORE CURRENT TRANSFORMER

- Split Core, easy installation
- Primary input 5A~3000A
- 100mA/100mV/333mV
- Wide inner window, allowing clamping of big cables
- Standard: IEC60044-1, EN60044-1, VDE0414-44-1, GB1208-2006



ESCT-B Series

SPLIT CORE CURRENT TRANSFORMER

- Split Core
- Primary input 100A~6000A
- Secondary output 5A / 1A
- Two building fixing methods: Base; Busbar mounting
- Wide inner window, allowing clamping of big cables or bus-bars
- Standard: IEC60044-1, EN60044-1, VDE0414-44-1, GB1208-2006

Specification	
Frequency	50-60Hz
Rated current	5A to 3000A loads
Rated output	100mA/100mV/333mV (AC)
Accuracy	± 1% from 20% to 120% of rated current
Phase angle	less than 2 degrees at 50% of rated current
Insulation voltage	600Vac
Maximum primary voltage	5000Vac (Insulated Conductor)
Dielectric strength	2.5KV/1mA/1min
Operating temperature	-15°C to 60°C.
Operating humidity	<85%
Case material	PC / UL94-V0
Bobbin	PBT
Core	Permalloy
Internal structure	Epoxy
Leads	UL 1015, Twisted Pair, 22AWG

Model	Rated Amps	Output	Accuracy
ESCT-U75	5	100mA/100mV/333mV	0.5 or 1
ESCT-U75	10	100mA/100mV/333mV	0.5 or 1
ESCT-U75	50	100mA/100mV/333mV	0.5 or 1
ESCT-U75	75	100mA/100mV/333mV	0.5 or 1
ESCT-U75	100	100mA/100mV/333mV	0.5 or 1
ESCT-U75	125	100mA/100mV/333mV	0.5 or 1
ESCT-U75	150	100mA/100mV/333mV	0.5 or 1
ESCT-U75	200	100mA/100mV/333mV	0.5 or 1
ESCT-U125	50	100mA/100mV/333mV	0.5 or 1
ESCT-U125	100	100mA/100mV/333mV	0.5 or 1
ESCT-U125	200	100mA/100mV/333mV	0.5 or 1
ESCT-U125	250	100mA/100mV/333mV	0.5 or 1
ESCT-U125	400	100mA/100mV/333mV	0.5 or 1
ESCT-U125	600	100mA/100mV/333mV	0.5 or 1
ESCT-U125	630	100mA/100mV/333mV	0.5 or 1
ESCT-U200	100	100mA/100mV/333mV	0.5 or 1
ESCT-U200	125	100mA/100mV/333mV	0.5 or 1
ESCT-U200	250	100mA/100mV/333mV	0.5 or 1
ESCT-U200	400	100mA/100mV/333mV	0.5 or 1
ESCT-U200	630	100mA/100mV/333mV	0.5 or 1
ESCT-U200	800	100mA/100mV/333mV	0.5 or 1
ESCT-U200	1000	100mA/100mV/333mV	0.5 or 1
ESCT-U200	2000	100mA/100mV/333mV	0.5 or 1
ESCT-U300	400	100mA/100mV/333mV	0.5 or 1
ESCT-U300	800	100mA/100mV/333mV	0.5 or 1
ESCT-U300	1000	100mA/100mV/333mV	0.5 or 1
ESCT-U300	1500	100mA/100mV/333mV	0.5 or 1
ESCT-U300	2500	100mA/100mV/333mV	0.5 or 1
ESCT-U300	3000	100mA/100mV/333mV	0.5 or 1

► Dimensions

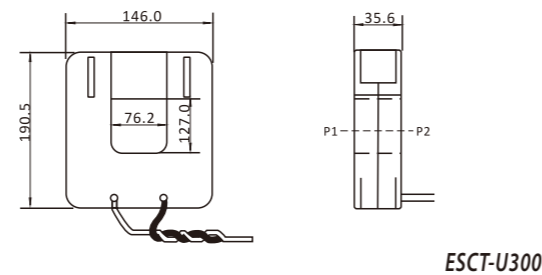
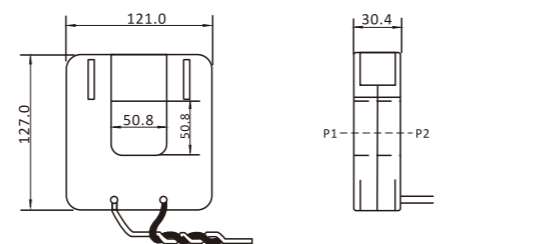
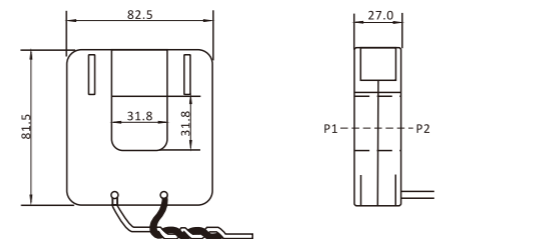
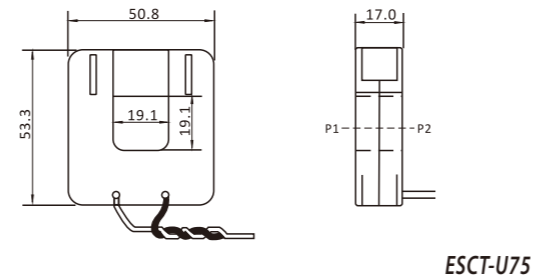

Specification	
Frequency	50Hz-60Hz
Rated current	100A to 6000A loads
Rated output	5A / 1A (AC)
Accuracy	Class 0.5 or 1 from 20% to 120% of rated current
Phase angle	less than 2 degrees at 50% of rated current
Insulation voltage	600Vac
Maximum primary voltage	5000Vac (Insulated Conductor)
Dielectric strength	2.5KV / 1mA / 1min
Operating temperature	-15°C to 60°C
Operating humidity	<85%
Case material	PC / UL94-V0
Bobbin	PBT
Internal structure	Epoxy

Model	Ratio (A)	Burden (VA)	
		Class:0.5	Class:1.0
ESCT-B23	100/5	-	15
ESCT-B23	150/5	-	1.5
ESCT-B23	200/5	-	1.5
ESCT-B23	250/5	-	2.5
ESCT-B23	300/5	1.5	-
ESCT-B23	400/5	2.5	-
ESCT-B58	250/5	-	1.5
ESCT-B58	400/5	1.5	-
ESCT-B58	600/5	2.5	-
ESCT-B58	800/5	3.75	-
ESCT-B58	1000/5	5	-
ESCT-B88	250/5	-	1.5
ESCT-B88	400/5	-	2.5
ESCT-B88	600/5	2.5	-
ESCT-B88	800/5	3.75	-
ESCT-B88	1000/5	5	-
ESCT-B812	500/5	-	2.5
ESCT-B812	600/5	-	2.5
ESCT-B812	750/5	2.5	-
ESCT-B812	800/5	2.5	-
ESCT-B812	1000/5	3.75	-
ESCT-B812	1200/5	5	-
ESCT-B812	1250/5	5	-
ESCT-B816	1000/5	5	-
ESCT-B816	1500/5	7.5	-
ESCT-B816	2000/5	10	-
ESCT-B816	2500/5	15	-
ESCT-B816	3000/5	20	-
ESCT-B816	4000/5	20	-
ESCT-B816	5000/5	20	-
ESCT-B816	6000/5	20	-

► Dimensions

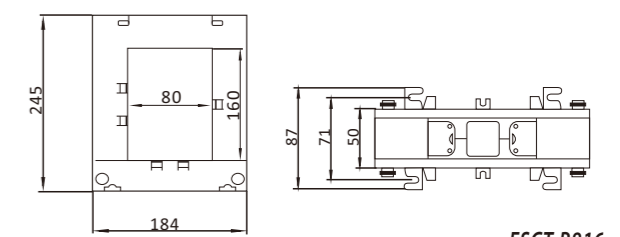
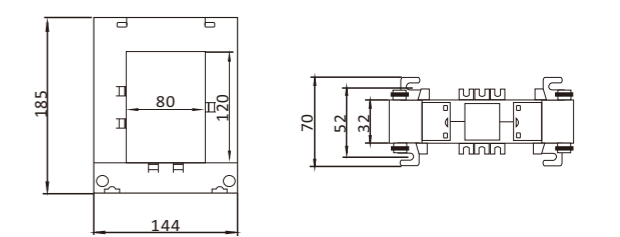
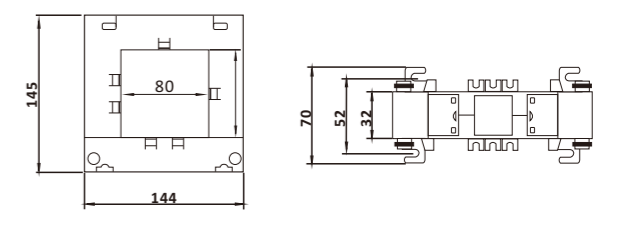
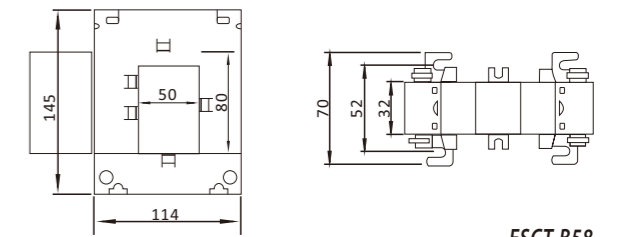
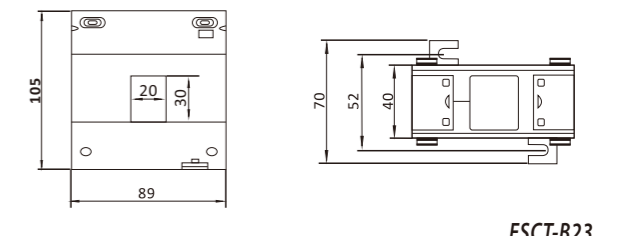



ESCT-RJ-1 Series SPLIT CORE CURRENT TRANSFORMER

- Split Core, easy installation
- RJ12 socket for quick connection and to eliminate wiring error
- Secondary output 333mV / 100mV / 100mA
- Safe operation
- Standard: IEC60044-1, EN60044-1, VDE0414-44-1, GB1208-2006



ESCT-RJ-3 Series 3-IN-1 CURRENT TRANSFORMER

- Cost effective three-phase moulded case
- Ratio's ranging from 60A~630A
- RJ12 socket for quick connection and to eliminate wiring error
- Busbar, DIN-rail and metal feet are supplied as standard

Specification	
Frequency	50Hz-60Hz
Rated current	5A to 1200A loads
Rated output	100mV/100mA / 333mV (AC)
Secondary terminals	RJ12
Accuracy	Class 0.5 or 1 from 20% to 120% of rated current
Phase angle	Less than 2 degrees at 50% of rated current
Insulation voltage	600 Vac
Maximum primary voltage	5000Vac (Insulated Conductor)
Dielectric strength	2.5 KV / 1mA / 1min
Operating temperature	-15°C to 60°C
Operating humidity	<85%
Case material	PC / UL 94-V0
Bobbin	PBT
Internal structure	Epoxy
Compliant with	IEC/EN60044/1

Model	Rated Amp(A)	Output	Accuracy
ESCT-RJ16	5	100mA/100mV/333mV	0.5 or 1
ESCT-RJ16	10	100mA/100mV/333mV	0.5 or 1
ESCT-RJ16	50	100mA/100mV/333mV	0.5 or 1
ESCT-RJ16	100	100mA/100mV/333mV	0.5 or 1
ESCT-RJ16	150	100mA/100mV/333mV	0.5 or 1
ESCT-RJ24	10	100mA/100mV/333mV	0.5 or 1
ESCT-RJ24	50	100mA/100mV/333mV	0.5 or 1
ESCT-RJ24	100	100mA/100mV/333mV	0.5 or 1
ESCT-RJ24	250	100mA/100mV/333mV	0.5 or 1
ESCT-RJ24	300	100mA/100mV/333mV	0.5 or 1
ESCT-RJ36	20	100mA/100mV/333mV	0.5 or 1
ESCT-RJ36	100	100mA/100mV/333mV	0.5 or 1
ESCT-RJ36	250	100mA/100mV/333mV	0.5 or 1
ESCT-RJ36	400	100mA/100mV/333mV	0.5 or 1
ESCT-RJ36	500	100mA/100mV/333mV	0.5 or 1
ESCT-RJ36	600	100mA/100mV/333mV	0.5 or 1
ESCT-RJ36	700	100mA/100mV/333mV	0.5 or 1
ESCT-RJ36	800	100mA/100mV/333mV	0.5 or 1
ESCT-RJ50	200	100mA/100mV/333mV	0.5 or 1
ESCT-RJ50	250	100mA/100mV/333mV	0.5 or 1
ESCT-RJ50	300	100mA/100mV/333mV	0.5 or 1
ESCT-RJ50	400	100mA/100mV/333mV	0.5 or 1
ESCT-RJ50	500	100mA/100mV/333mV	0.5 or 1
ESCT-RJ50	600	100mA/100mV/333mV	0.5 or 1
ESCT-RJ50	700	100mA/100mV/333mV	0.5 or 1
ESCT-RJ50	800	100mA/100mV/333mV	0.5 or 1
ESCT-RJ50	1000	100mA/100mV/333mV	0.5 or 1
ESCT-RJ50	1200	100mA/100mV/333mV	0.5 or 1

Specification	
Frequency	50Hz-60Hz
Rated current	60A to 1600A loads
Rated output	100mA / 100mV/333mV (AC)
Secondary terminals	RJ12
Accuracy	Class 0.5 or 1 from 20% to 120% of rated current
Phase angle	Less than 2 degrees at 50% of rated current
Insulation voltage	600 Vac
Maximum primary voltage	5000Vac (Insulated Conductor)
Dielectric strength	2.5 KV / 1mA / 1min
Operating temperature	-15°C to 60°C
Operating humidity	<85%
Case material	PC / UL 94-V0
Bobbin	PBT
Internal structure	Epoxy
Compliant with	IEC/EN60044/1

Model	Rated Amp(A)	Output	Accuracy
ESCT-RJ325	60	100mV/100mA/333mV	0.5 or 1
ESCT-RJ325	100	100mV/100mA/333mV	0.5 or 1
ESCT-RJ325	120	100mV/100mA/333mV	0.5 or 1
ESCT-RJ325	125	100mV/100mA/333mV	0.5 or 1
ESCT-RJ325	150	100mV/100mA/333mV	0.5 or 1
ESCT-RJ325	160	100mV/100mA/333mV	0.5 or 1
ESCT-RJ325	200	100mV/100mA/333mV	0.5 or 1
ESCT-RJ335	63	100mV/100mA/333mV	0.5 or 1
ESCT-RJ335	125	100mV/100mA/333mV	0.5 or 1
ESCT-RJ335	150	100mV/100mA/333mV	0.5 or 1
ESCT-RJ335	200	100mV/100mA/333mV	0.5 or 1
ESCT-RJ335	250	100mV/100mA/333mV	0.5 or 1
ESCT-RJ345	250	100mV/100mA/333mV	0.5 or 1
ESCT-RJ345	300	100mV/100mA/333mV	0.5 or 1
ESCT-RJ345	400	100mV/100mA/333mV	0.5 or 1
ESCT-RJ345	500	100mV/100mA/333mV	0.5 or 1
ESCT-RJ345	600	100mV/100mA/333mV	0.5 or 1
ESCT-RJ345	630	100mV/100mA/333mV	0.5 or 1
ESCT-RJ370	600	100mV/100mA/333mV	0.5 or 1
ESCT-RJ370	630	100mV/100mA/333mV	0.5 or 1
ESCT-RJ370	800	100mV/100mA/333mV	0.5 or 1
ESCT-RJ370	1200	100mV/100mA/333mV	0.5 or 1
ESCT-RJ370	1600	100mV/100mA/333mV	0.5 or 1

► Dimensions

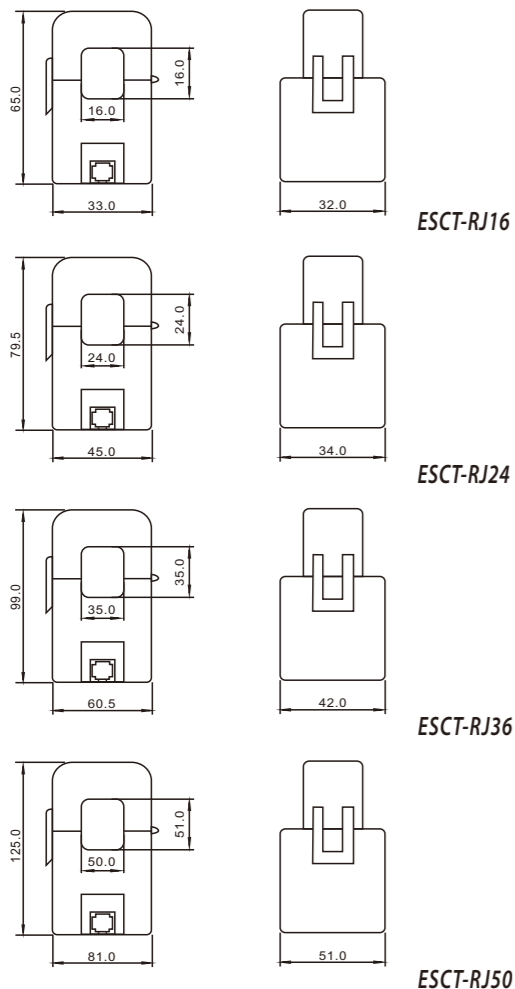

► Dimensions

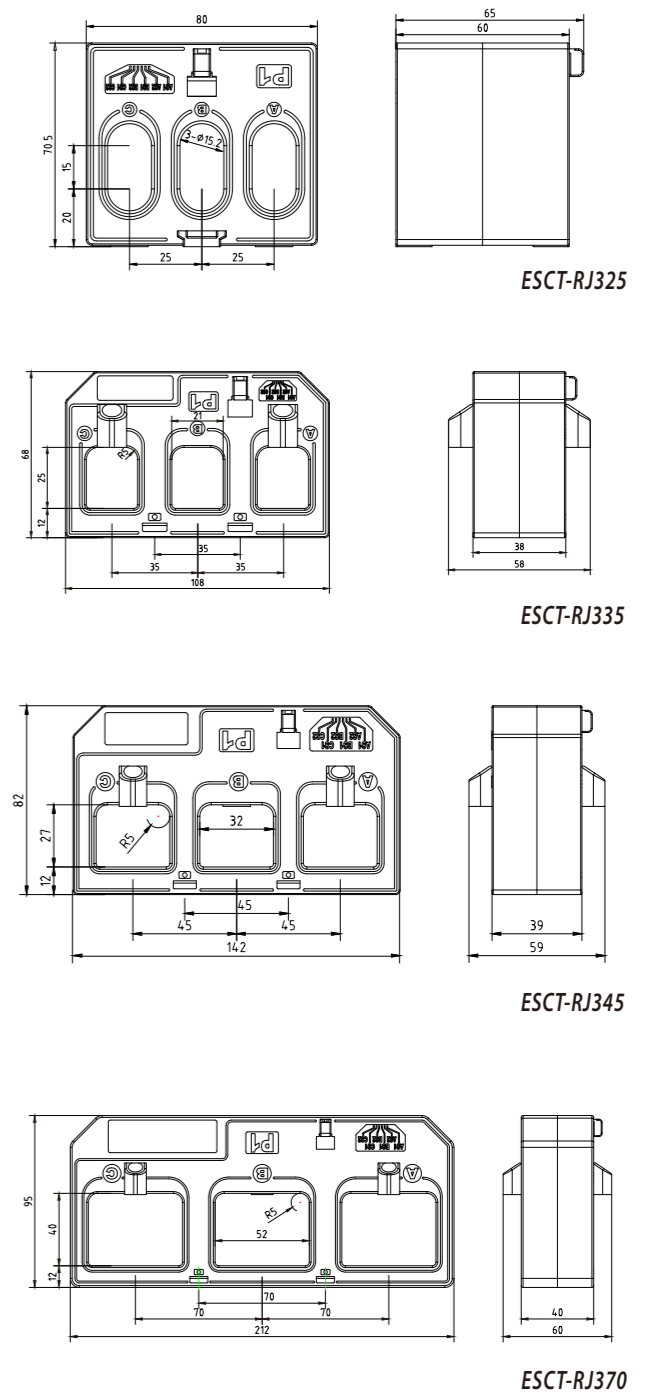



ESCT-C Series 3-IN-1 CURRENT TRANSFORMER

- Cost effective three-phase moulded case
- Ratio's ranging from 60/5 to 630/5
- Integrated wire sealable terminal cover
- Busbar, DIN-rail and metal feet mounting hardware supplied
- Combined M4 posi /slot screw

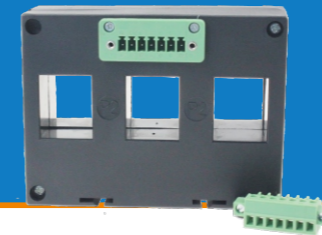

ESCT-SC Series 3-IN-1 CURRENT TRANSFORMER

- Cost effective three-phase moulded case
- Ratio's ranging from 60/5 to 630/5
- Plug-in quite connection, 80% labor saving
- Lockable terminal for safety
- Both available for Busbar or DIN Rail mounted

Specification	
Rated current	60A to 630A loads
Rated output	5A (AC)
Accuracy	Class 0.5 or 1 from 20% to 120% of rated current
Phase angle	Less than 2 degrees at 50% of rated current
Insulation voltage	600 Vac
Maximum primary voltage	5000 Vac (Insulated Conductor)
Dielectric strength	2.5 KV /1mA /1 min
Operating temperature	-15°C to 60°C
Operating humidity	<85%
Case material	PC / UL 94-V0
Bobbin	PBT
Internal structure	Epoxy

► Dimensions

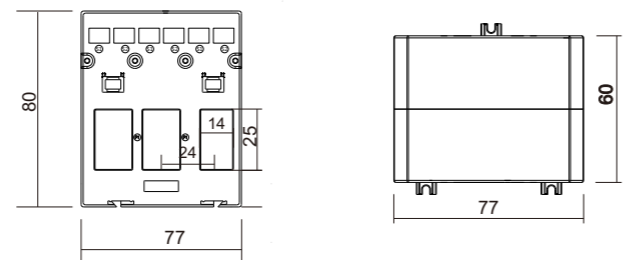

ESCT-C325

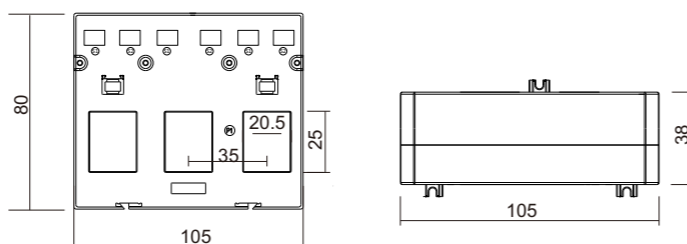

ESCT-C335

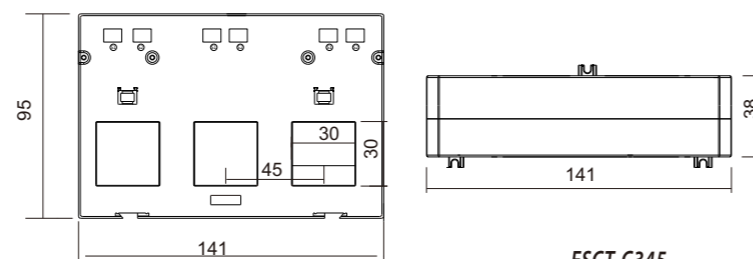

ESCT-C345

Model	Ratio (A)	Burden (VA)	
		Class:0.5	Class:1.0
ESCT-C325	60/5	-	1
ESCT-C325	100/5	-	1.5
ESCT-C325	125/5	1.5	1.5
ESCT-C325	150/5	1.5	1.5
ESCT-C325	200/5	1.5	1.5
ESCT-C335	100/5	-	1.5
ESCT-C335	125/5	-	2.5
ESCT-C335	150/5	-	3.75
ESCT-C335	160/5	1.5	1.5
ESCT-C335	200/5	1.5	1.5
ESCT-C335	250/5	1.5	1.5
ESCT-C345	250/5	1.5	1.5
ESCT-C345	300/5	2.5	2.5
ESCT-C345	400/5	2.5	2.5
ESCT-C345	500/5	2.5	2.5
ESCT-C345	600/5	2.5	2.5
ESCT-C345	630/5	2.5	2.5

Specification	
System voltage	720V maximum
Test voltage	3KV for 1 minute
System frequency	50Hz or 60Hz
Primary ratings	60A to 630A
Short circuit thermal current	60 x rated primary current
Overload withstand	1.2 x rated current continuously
Rated dynamic current	2.55 x Ith
Secondary terminals	M4 screw terminals
Enclosure	Flame retardant grad classified UL 94V-0
Aperture holes centers	25,35,45mm
Mounting hardware	Plug-in metal feet for wall or base Mounting
	Bus-bar and DIN-rail
Compliant with	IEC/EN60044-1

Model	Ratio (A)	Burden (VA)	
		Class:0.5	Class:1.0
ESCT-SC325	60/1	-	1
ESCT-SC325	100/1	-	1.5
ESCT-SC325	125/1	1.5	1.5
ESCT-SC325	150/1	1.5	1.5
ESCT-SC325	300/1	1.5	1.5
ESCT-SC335	100/1	-	1.5
ESCT-SC335	125/1	-	1.5
ESCT-SC335	150/1	-	1.5
ESCT-SC335	160/1	1.5	1.5
ESCT-SC335	200/1	1.5	1.5
ESCT-SC335	250/1	1.5	1.5
ESCT-C345	250/1	1.5	1.5
ESCT-C345	300/1	2.5	2.5
ESCT-C345	400/1	2.5	2.5
ESCT-C345	500/1	2.5	2.5
ESCT-C345	600/1	2.5	2.5
ESCT-C345	630/1	2.5	2.5

► Dimensions

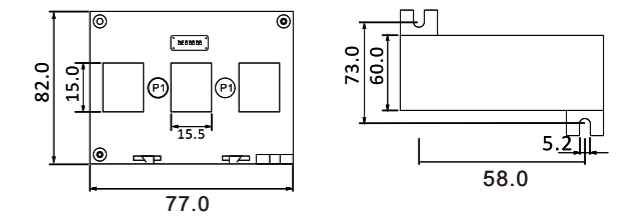

ESCT-SC325

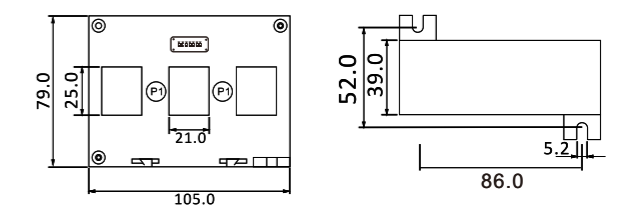

ESCT-SC335

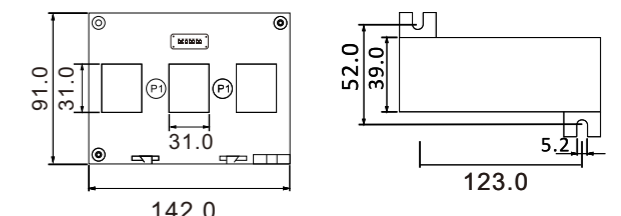

ESCT-SC345



ESCT-RJ-3 Series

- Split Core, easy installation
- RJ12 socket for quick connection and to eliminate wiring error
- Secondary output 333mV/100mV/1000mA/40mA
- Safe operation
- Standard: IEC60044-1, EN60044-1, VDE0414-44-1, GB1208-2006



ESCT-P Series

PUNCTURE CURRENT TRANSFORMER

- Split Core, easy installation
- Puncture function
- NTC temperature (Optional)
- Waterproof
- Flexible installation method
- Primary input 5A~1000A

Specification	
Frequency	50Hz-60Hz
Rated current	5A to 600A loads
Rated output	333mV/100mV/100mA/40mA (AC)
Accuracy	Class 0.5 or 1 from 20% to 120% of rated current
Phase angle	less than 2 degrees at 50% of rated current
Insulation voltage	600Vac
Maximum primary voltage	5000Vac (Insulated Conductor)
Dielectric strength	2.5KV/1mA/1min
Operating temperature	-15°C to +75°C
Operating humidity	<85%
Case material	PC / UL94-V0
Bobbin	PBT
Core	Permalloy
Internal structure	Epoxy
Leads	UL 1015, Twisted Pair, 22AWG

► Introduction:

The ESCT-RJ-3 series is three phase current transformer with 3 split core CTs, giving the unit wide range of primary current input and saving labor of installation. The S1 and S2 of each phase are integrated together in same wire leading to RJ12 port. The definition of the RJ12 port is:

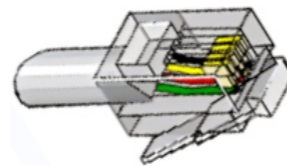

- Yellow: I_c -
- Red: I_c +
- Orange: I_b -
- Black: I_b +
- White: I_a -
- Brown: I_a +

► Dimensions (Unit:mm)

Model	Rated Amps (A)	Output	Accuracy
ESCT-TU10	5	333mV/100mV/100mA/40mA	0.5/1/3
ESCT-TU10	10	333mV/100mV/100mA/40mA	0.5/1/3
ESCT-TU10	20	333mV/100mV/100mA/40mA	0.5/1/3
ESCT-TU10	50	333mV/100mV/100mA/40mA	0.5/1/3
ESCT-TU10	80	333mV/100mV/100mA/40mA	0.5/1/3
ESCT-TU16	10	333mV/100mV/100mA/40mA	0.5/1/3
ESCT-TU16	50	333mV/100mV/100mA/40mA	0.5/1/3
ESCT-TU16	100	333mV/100mV/100mA/40mA	0.5/1/3
ESCT-TU16	120	333mV/100mV/100mA/40mA	0.5/1/3
ESCT-TU24	10	333mV/100mV/100mA/40mA	0.5/1/3
ESCT-TU24	50	333mV/100mV/100mA/40mA	0.5/1/3
ESCT-TU24	100	333mV/100mV/100mA/40mA	0.5/1/3
ESCT-TU24	250	333mV/100mV/100mA/40mA	0.5/1/3
ESCT-TU24	400	333mV/100mV/100mA/40mA	0.5/1/3
ESCT-TU36	20	333mV/100mV/100mA/40mA	0.5/1/3
ESCT-TU36	100	333mV/100mV/100mA/40mA	0.5/1/3
ESCT-TU36	250	333mV/100mV/100mA/40mA	0.5/1/3
ESCT-TU36	400	333mV/100mV/100mA/40mA	0.5/1/3
ESCT-TU36	600	333mV/100mV/100mA/40mA	0.5/1/3

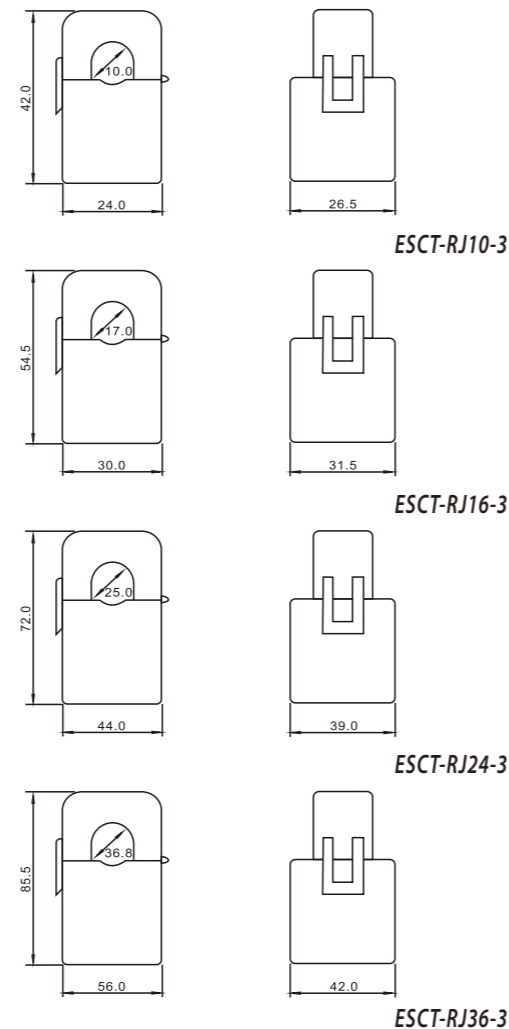

Specification	
Frequency	0.02-2KHz
Max. current input	ESCT-P16: 250A/ESCT-P24: 300A/ESCT-P36: 800A
Current output	100mA/100mV/333mV (AC)
Phase difference of the rated value	ESCT-P16: ≤ 50' (100A) ESCT-P24: ≤ 50' (100A) ESCT-P36: ≤ 45' (100A)
Linearity	0.3 (I _b 1%~Max)
Accuracy	0.50%
Temperature sensor	0°C to +40°C
Phase difference change	≤ 15' (I _b 1%~Max)
Isolation withstand voltage	500V/min
Operating temperature	-30°C ~ +75°C
Storage temperature	-40°C ~ +80°C
Load resistance	≤ 20 (Max. current input)

► Dimensions (Unit: mm)

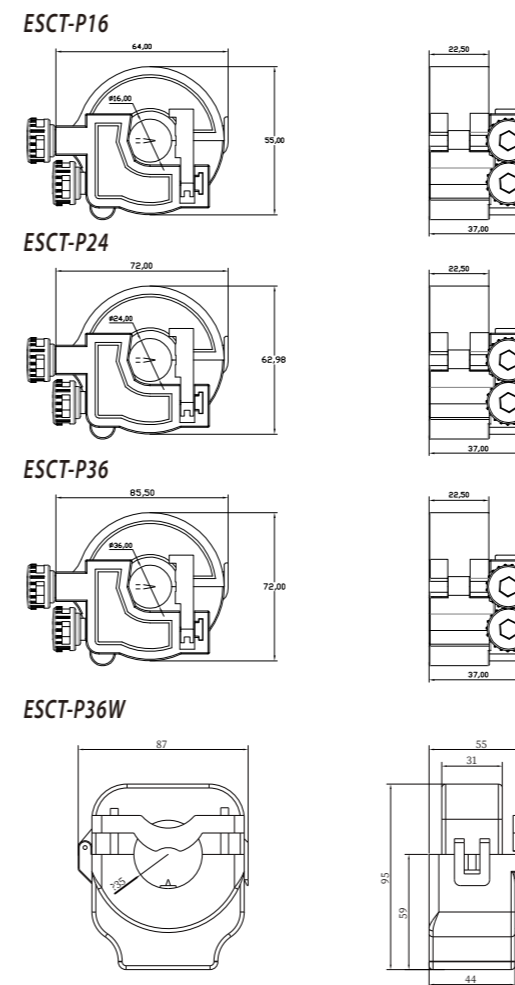

Model	Rated Amps (A)	Output	Accuracy
ESCT-P16T	5	100mA/100mV/333mV	0.5 or 1
ESCT-P16T	63	100mA/100mV/333mV	0.5 or 1
ESCT-P16T	100	100mA/100mV/333mV	0.5 or 1
ESCT-P16T	160	100mA/100mV/333mV	0.5 or 1
ESCT-P16T	250	100mA/100mV/333mV	0.5 or 1
ESCT-P24T	100	100mA/100mV/333mV	0.5 or 1
ESCT-P24T	200	100mA/100mV/333mV	0.5 or 1
ESCT-P24T	250	100mA/100mV/333mV	0.5 or 1
ESCT-P24T	300	100mA/100mV/333mV	0.5 or 1
ESCT-P24T	400	100mA/100mV/333mV	0.5 or 1
ESCT-P36T	200	100mA/100mV/333mV	0.5 or 1
ESCT-P36T	250	100mA/100mV/333mV	0.5 or 1
ESCT-P36T	300	100mA/100mV/333mV	0.5 or 1
ESCT-P36T	400	100mA/100mV/333mV	0.5 or 1
ESCT-P36T	500	100mA/100mV/333mV	0.5 or 1
ESCT-P36T	600	100mA/100mV/333mV	0.5 or 1
ESCT-P36T	630	100mA/100mV/333mV	0.5 or 1
ESCT-P36T	800	100mA/100mV/333mV	0.5 or 1
ESCT-P16	5	100mA/100mV/333mV	0.5 or 1
ESCT-P16	63	100mA/100mV/333mV	0.5 or 1
ESCT-P16	100	100mA/100mV/333mV	0.5 or 1
ESCT-P16	160	100mA/100mV/333mV	0.5 or 1
ESCT-P16	250	100mA/100mV/333mV	0.5 or 1
ESCT-P24	100	100mA/100mV/333mV	0.5 or 1
ESCT-P24	200	100mA/100mV/333mV	0.5 or 1
ESCT-P24	250	100mA/100mV/333mV	0.5 or 1
ESCT-P24	300	100mA/100mV/333mV	0.5 or 1
ESCT-P24	400	100mA/100mV/333mV	0.5 or 1
ESCT-P36	200	100mA/100mV/333mV	0.5 or 1
ESCT-P36	250	100mA/100mV/333mV	0.5 or 1
ESCT-P36	300	100mA/100mV/333mV	0.5 or 1
ESCT-P36	400	100mA/100mV/333mV	0.5 or 1
ESCT-P36	500	100mA/100mV/333mV	0.5 or 1
ESCT-P36	600	100mA/100mV/333mV	0.5 or 1
ESCT-P36	800	100mA/100mV/333mV	0.5 or 1
ESCT-P36W	200	100mA/100mV/333mV	0.5 or 1
ESCT-P36W	400	100mA/100mV/333mV	0.5 or 1
ESCT-P36W	600	100mA/100mV/333mV	0.5 or 1
ESCT-P36W	800	100mA/100mV/333mV	0.5 or 1
ESCT-P36W	1000	100mA/100mV/333mV	0.5 or 1



ESCT-ABO Series
SOLID CORE CURRENT TRANSFORMER

- Two built in fixing methods: 1 side base; Busbar mounting
- Built in hinged terminal cover
- Built in transparent cover for name plate
- Wide range accuracy (3,1,0.5,0.5s, 0.2,0.2s)
- Primary current from 50A to 3000A



ESCT-DM Series
SOLID CORE CURRENT TRANSFORMER

- Two built in fixing methods: 1 side base; Busbar mounting
- Built in hinged terminal cover
- Primary current from 50A to 300A

Specification

Rated Frequency	50Hz-60Hz
Rated current	5A to 3000A loads
Rated output	5A, 1A, 0.5A, 0.25A, 0.1A
Accuracy	± 1% from 20% to 120% of rated current
Rated short-time thermal current (Ith)	60In
Rated voltage (Um)	1.2In
Operating temperature	-10°C~50°C
Housing self-extinguishing class	V0
Standard	IEC60044-1, EN60044-1, VDE0414-44-1, GB1208-2006

Model	Ratio(A)	Burden (VA)	
		Class:0.5	Class:1.0
ESCT-ABO-30	50/5	1.5	2.5
ESCT-ABO-30	60/5	1.5	2.5
ESCT-ABO-30	75/5	2.5	3.75
ESCT-ABO-30	100/5	3.75	5
ESCT-ABO-30	150/5	5	5
ESCT-ABO-30	200/5	5	5
ESCT-ABO-30	250/5	5	5
ESCT-ABO-30	300/5	5	5
ESCT-ABO-40	75/5	1.5	1.5
ESCT-ABO-40	80/5	1.5	1.5
ESCT-ABO-40	100/5	2.5	2.5
ESCT-ABO-40	150/5	3.75	5
ESCT-ABO-40	200/5	5	5
ESCT-ABO-40	250/5	5	5
ESCT-ABO-40	300/5	5	5
ESCT-ABO-40	400/5	5	5
ESCT-ABO-40	500/5	5	5
ESCT-ABO-60	200/5	5	5
ESCT-ABO-60	250/5	5	5
ESCT-ABO-60	300/5	5	5
ESCT-ABO-60	400/5	5	5
ESCT-ABO-60	500/5	5	5
ESCT-ABO-60	600/5	5	10
ESCT-ABO-60	750/5	5	10
ESCT-ABO-60	800/5	5	10
ESCT-ABO-60	1000/5	5	10
ESCT-ABO-100	800/5	5	10
ESCT-ABO-100	1000/5	5	10
ESCT-ABO-100	1200/5	7.5	10
ESCT-ABO-100	1500/5	7.5	10
ESCT-ABO-100	1600/5	7.5	10
ESCT-ABO-100	2000/5	10	15
ESCT-ABO-100	2500/5	10	15
ESCT-ABO-100	3000/5	10	15

► Introduction

ESCT-ABO perfect designed plastic case current transformer, advanced snap on body, high accuracy (up to Class 0.2S), humanization transparent cover and lead seal hole design make the CT very easy to identify after long-term use and perfect anti-stealing electricity.

► Dimension

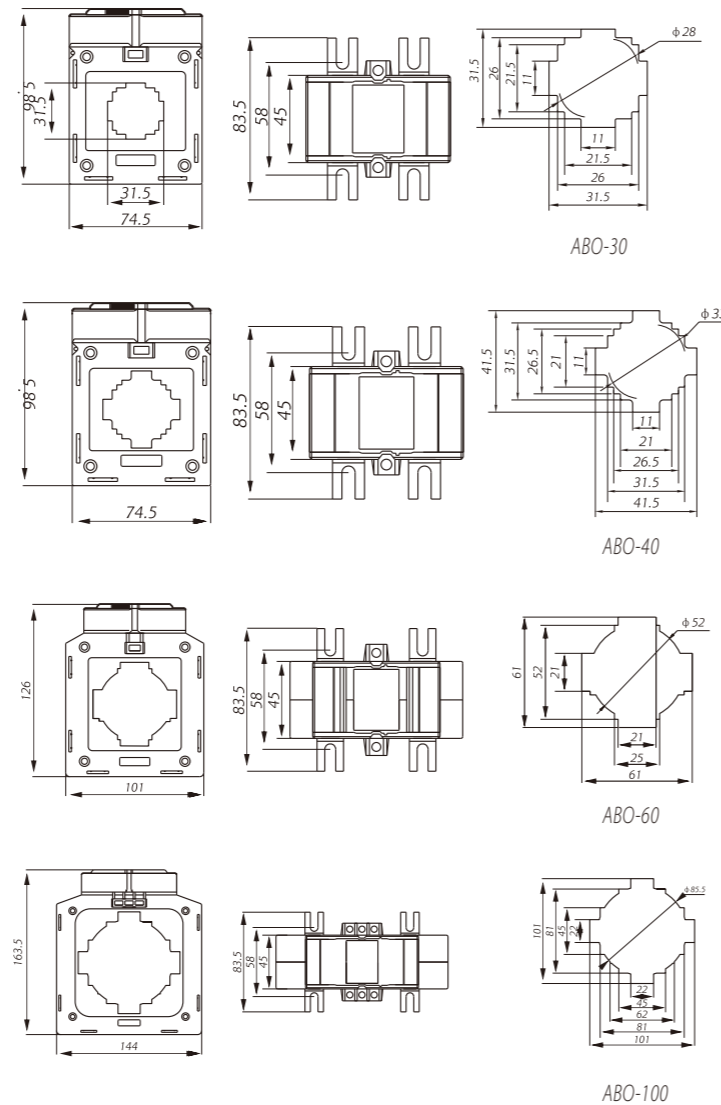

Specification

Rated Frequency	50Hz-60Hz
Rated current	50A to 300A loads
Rated test voltage	3kV AC (1min)
Rated short-time thermal current (Ith)	60In
Rated voltage (Um)	0.72Kv AC.
Rated output	5A or 1A
Rated voltage (Um)	1.2In
Operating temperature	-10°C~50°C
Housing self-extinguishing class	V0
Safety factor	Fs5
Standard	IEC60044-1, EN60044-1, VDE0414-44-1, GB1208-2006

Model	Rated Amps	Burden (VA) / Class 1.0
ESCT-DM-20/30	50/5	1
ESCT-DM-20/30	60/5	1.25
ESCT-DM-20/30	75/5	1.5
ESCT-DM-20/30	80/5	1.5
ESCT-DM-20/30	100/5	2.5
ESCT-DM-20/30	120/5	2.5
ESCT-DM-20/30	150/5	2.5
ESCT-DM-20/30	200/5	3.75
ESCT-DM-20/30	250/5	3.75
ESCT-DM-20/30	300/5	3.75
ESCT-DM-20/35	50/5	-
ESCT-DM-20/35	60/5	-
ESCT-DM-20/35	75/5	1.5
ESCT-DM-20/35	80/5	1.5
ESCT-DM-20/35	100/5	2.5
ESCT-DM-20/35	120/5	2.5
ESCT-DM-20/35	150/5	2.5
ESCT-DM-20/35	200/5	2.5
ESCT-DM-20/35	250/5	3.75
ESCT-DM-20/35	300/5	3.75

► Introduction

ESCT-DM is world-famous MINI design plastic case current transformer, snap on body, be widely used in generators. It is available for connecting with cable, and also available for connecting with Busbar. Its primary currents between 50A~300A with 5A secondaries with up to Class1.0 accuracy Performance.

► Dimension

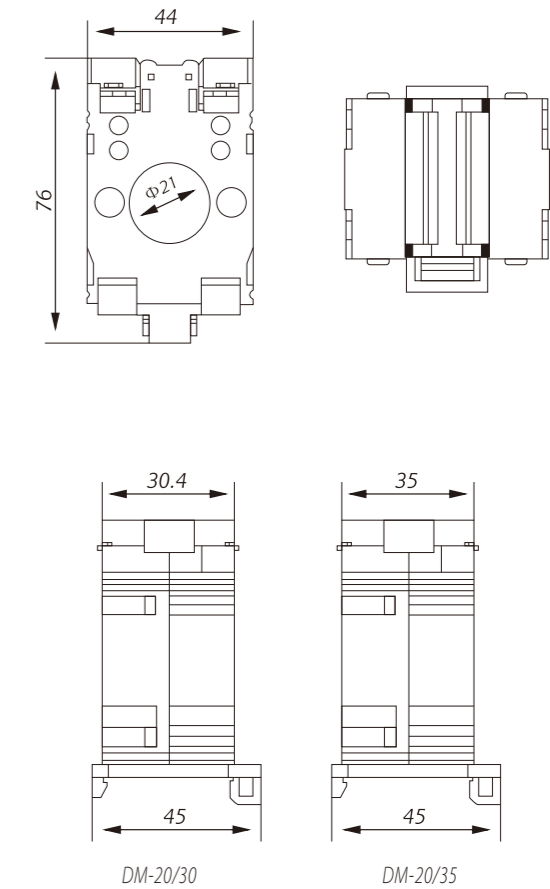

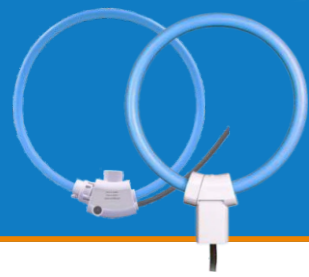

ESCT-RC

FLEXIBLE ROGOWSKI COIL CURRENT SENSOR

- Flexible and light weights
- Easy & quick installation in tight spaces
- No danger from open-circuited secondary
- No core saturation or damage if overloaded
- Excellent linearity
- Multi- size are available

Specification	
Current range	10A to 100kA
Rated output	85mV/ per 1000A @ 50Hz without integrator 50mV/ per 1000A @ 50Hz without integrator
Accuracy	±1% from 5% to 120% of rated current with integrator(45-65Hz)
Phase angle	≤±1°5% to 120% from 5% to 120% of rated current
Linear	0.5%
Frequency	1Hz-1MHz ,50/60 Hz nominal
Work Voltage	600V
Coil diameter	10.5mm,12mm or as customer order
Window size	16mm,24mm or as per customer ordered
Wire lead	2 meters sheath cable or as customers order
Withstand voltage	3000V
Operating temperature	-30°C-+70°C
IP class	IP65
Certification	CE / RoHS

Model	Rated Amps(A)	Class	Coil Length	Window Size		Type No.
				A	B	
ESCT-RC16	100	0.5	80	22	16	C
ESCT-RC24	300	0.5	97	27.5	24	C
ESCT-RC36	600	0.5	130	36	37	C
EACT-RC45	500	0.5	140	65	45	D
ESCT-RC60	500	0.5	200	60	50	A
ESCT-RC100	1000	0.5	395	135	100	B
ESCT-RC105	1500	0.5	350	105	100	A
ESCT-RC150	3000	0.5	525	165	150	B
ESCT-RC200	6000	0.5	665	240	200	B
ESCT-RC240	10000	0.5	800	245	240	A

Coil Type:	Type A			Type B			Type C			Type D
Model:	RC60	RC105	RC240	RC100	RC150	RC200	RC16	RC24	RC36	RC45
A: Window Size A	60	105	245	135	165	210	22	27.5	36	65
B: Window Size B	50	100	240	100	150	200	16	24	37	45
C: Coil O.D.	66	121	261	151	181	226	24	39.5	48	81
D: Coil Section	8			6			8			8
E: Lead Cable Total Length	2000									
F: Coil Length	200	350	800	395	525	665	80	97	130	205

Type A:

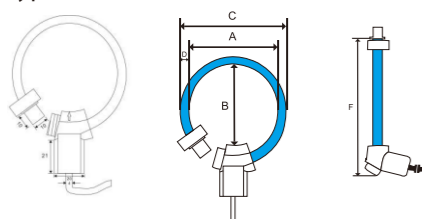

Type B:

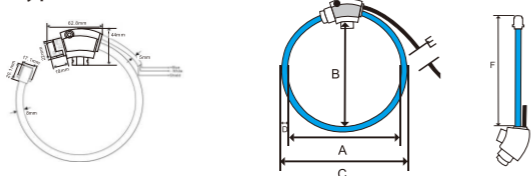

Type C:

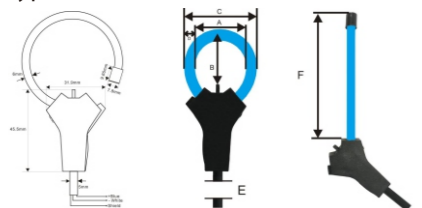

Type D:

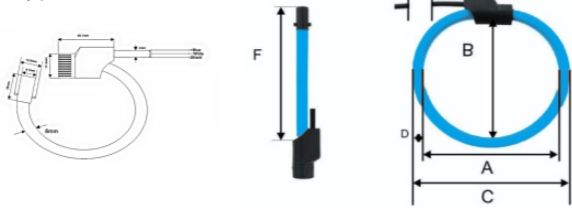

ESCT-RCI Series

SINGLE PHASE/THREE PHASE INTEGRATOR

- High read accuracy Class0.2/Class 0.5
- Low power consumption
- Adaptive with different kinds of coils
- Wide range of rated input: 500A-100kA

Single Phase DIN Rail 1A/5A Integrator		
Model	ESCT-RCI-A01	ESCT-RCI-A05
Rated output	1A AC	5A AC
Max. Output(overload)	3A AC(<1s, after the start overheating protection)	7A AC(<1s, after the start overheating protection)
Rated ratio	500A,3000A,10kA,...100kA	
Read accuracy	1%typical at 5% (≥10A) to 100% of rated Current @25°C	
Phase error	≤0.5°	
Linearity	±0.2% of reading (5% to 100% of range)	
Bandwidth	30Hz to 5kHz	30Hz to 5kHz(-3dB)
Max. burden	1Ω	0.8Ω
Power supply	85~265V AC/DC (Powered from 2pcs 85~265 to 8VDC 40W SMPS)	
Power consumption	5W	40W
Temperature drift	200ppm/°C	
Operating temperature	-20°C to +70°C	
Storage temperature	-30°C to +90°C	
Relative humidity	80% max. without condensation	
Protection degree	IP20	

Three Phase DIN Rail 1A/333mV Integrator		
Model	ESCT-RCI-01	ESCT-RCI-03
Rated output	1A AC	333mV AC
Rated ratio	100A,600A,1000A,3000A,6000A	
Read accuracy	0.5% typical at 1%(≥10A) to 110% of rated Current @25°C	
Phase error	≤0.5°	
Linearity	±0.2% of reading (10% to 120% of range)	
Bandwidth	30Hz to 5kHz	
Max. burden	0.5Ω(each phase)	
Power supply	12V/24V DC	
Power consumption	10W	
Temperature drift	200ppm/°C	
Operating temperature	-20°C to +70°C	
Storage temperature	-30°C to +90°C	
Relative humidity	80% max. without condensation	
Protection degree	IP20	

Single Phase 333mV Integrator	
Model	ESCT-RCI-9.1
Rated output	333mV AC
Max. Output(overload)	4.8V AC pp
Instant response time	≤1ms
Power consumption	70mW
Bandwidth	10Hz to 10kHz
Power supply	6-12V DC
Rated output	500A,3000A,10kA,...100kA
Read accuracy	0.5% typical at 5%(≥20A) to 120% F.S.@25°C
Phase error	≤0.5°
Linearity	±0.2% of reading (5% to 120% of range)
Operating temperature	-20°C to +70°C
Storage temperature	-30°C to +90°C

► Dimensions(Unit: mm)

ESCT-RCI-9.1

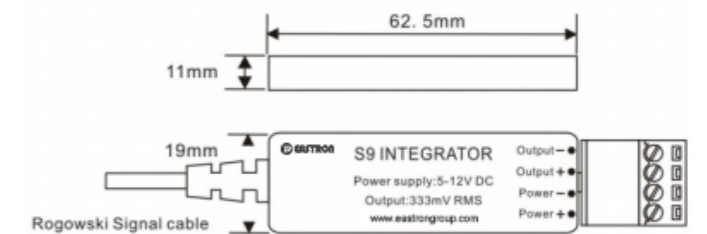

ESCT-RCI-01/03

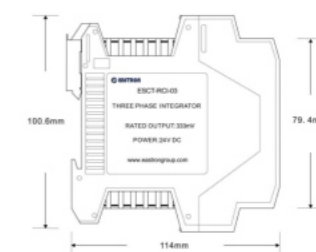

ESCT-RCI-A01/05

